

Mini pages

Add mini pages

Version 8.0



This documentation is provided under restrictions on use and are protected by intellectual property laws. Except as expressly permitted in your license agreement or allowed by law, you may not use, copy, reproduce, translate, broadcast, modify, license, transmit, distribute, exhibit, perform, publish or display any part, in any form, or by any means. Reverse engineering, disassembly, or decompilation of this documentation, unless required by law for interoperability, is prohibited.

The information contained herein is subject to change without notice and is not warranted to be error-free. If you find any errors, please report them to us in writing.

Table of Contents

Add mini pages

4

Add mini pages

PRODUCTS: [ALL CREATIO PRODUCTS](#)

Mini pages in Creatio are “light” versions of regular record edit pages. They show a limited number of fields from regular record pages and provide better control over the UX of your users who work with the section records.

Mini pages enable your users to perform the following operations with fewer clicks:

- preview section records without having to open standard record pages;
- quickly add and edit section records;
- run certain actions right from a record mini page (e.g., making a call or sending an email message);
- open the linked records displayed on the mini page in one click, etc.

Note. Learn more about working with mini pages of different records in the “[Mini pages](#)” article.

After you set up your regular section pages in the Section Wizard, you can start configuring mini pages.

To configure a mini page in Creatio:



1. Open the section, where you need to set up mini pages.
2. In the section, click [*View*] → **Open Section Wizard**.
3. In the [*Mini page*] area, select the functions for the mini pages in this section ([Fig. 1](#)):
 - a. **Add record** – the mini page will open when a user clicks [*Add*] in the section. The user can then open the complete record page by clicking  on the mini page.
 - b. **Edit record** – this will enable the users to edit existing records via the mini page. This option adds an “edit” button to the mini page. The user can click  in the top right corner of the mini page to edit the record.
 - c. **View record** – this will enable the users to preview the record data without opening the standard record edit page. The mini page will pop up when the user hovers their cursor over the record link shown in a list.

Fig. 1 Enabling mini pages for adding and viewing section records



4. Click **Edit mini page** to switch to Mini Page Designer.
5. In the Mini Page Designer, select the mini page mode (**Add mode/Edit mode/View mode**) for the function(s)

selected on step 3.

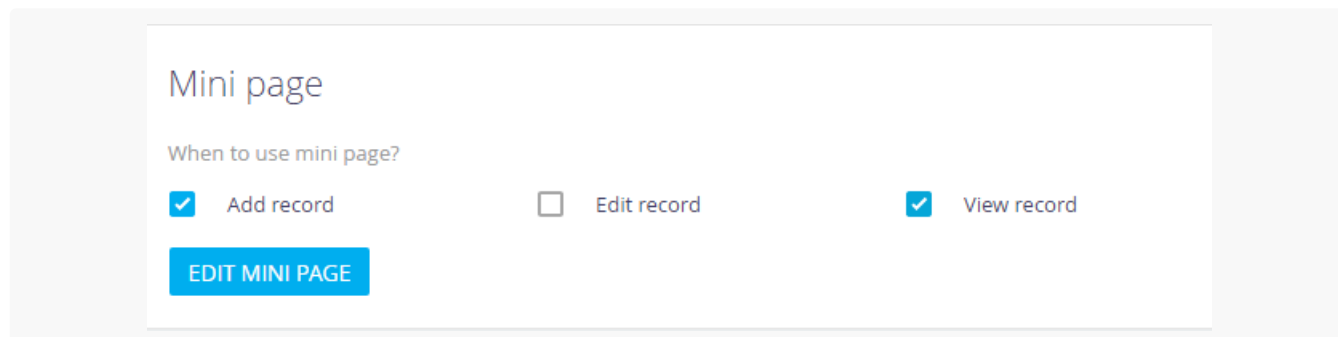
Note. The “HeaderContainer” element at the top of the field setup area of the Mini Page Designer is non-editable. It is used to display the mini page caption correctly.

6. Set up the layout of the corresponding mini pages:
 - a. Drag the necessary columns from the [*Page elements*] area to the field setup area ([Fig. 2](#)).
 - b. Click  to modify column properties ([Fig. 3](#))

Fig. 2 Setting up the layout of a mini page



The screenshot shows the 'Requests: Section' configuration page. At the top, there are 'SAVE' and 'CANCEL' buttons, and a breadcrumb trail: '< SECTION CASES BUSINESS PROCESSES >'. The main content is divided into four sections:

- Section settings:** Includes a 'Title*' field with the value 'Requests', a 'Code*' field with the value 'UsrCutsomRequests', and an 'Indexing for full-text search' checkbox which is currently unchecked.
- Section pages:** Features an 'EDIT PAGE' button and a '+ Add page' link.
- Mini page:** Contains a 'When to use mini page?' section with three checkboxes: 'Add record', 'Edit record', and 'View record', all of which are unchecked. Below this is an 'EDIT MINI PAGE' button.
- Approval:** Includes an 'Enable approval in section' checkbox, which is currently unchecked.

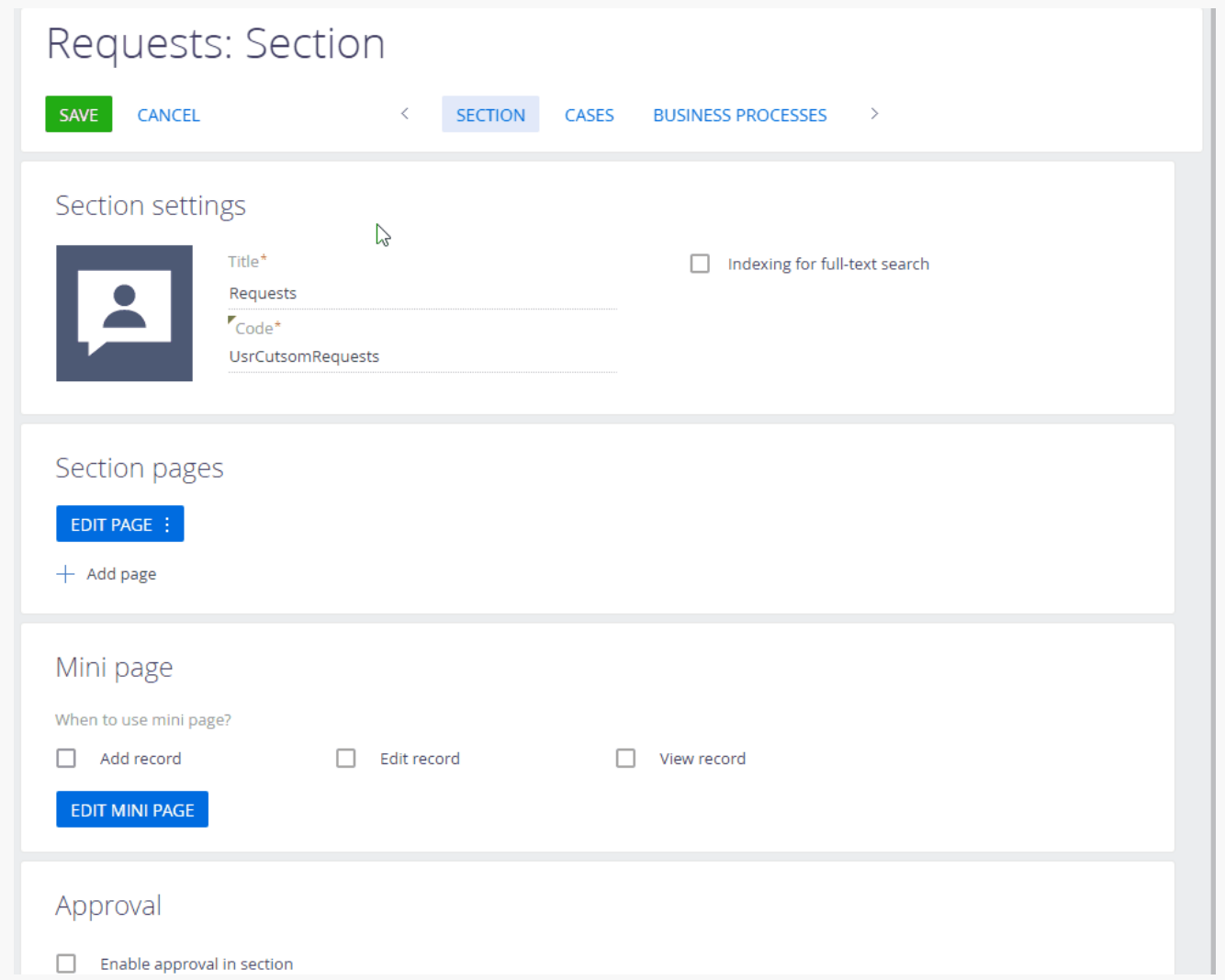
Note. Working with column properties on mini pages is similar to that of the regular section page. Read more >>>

Fig. 3 Editing the mini page columns

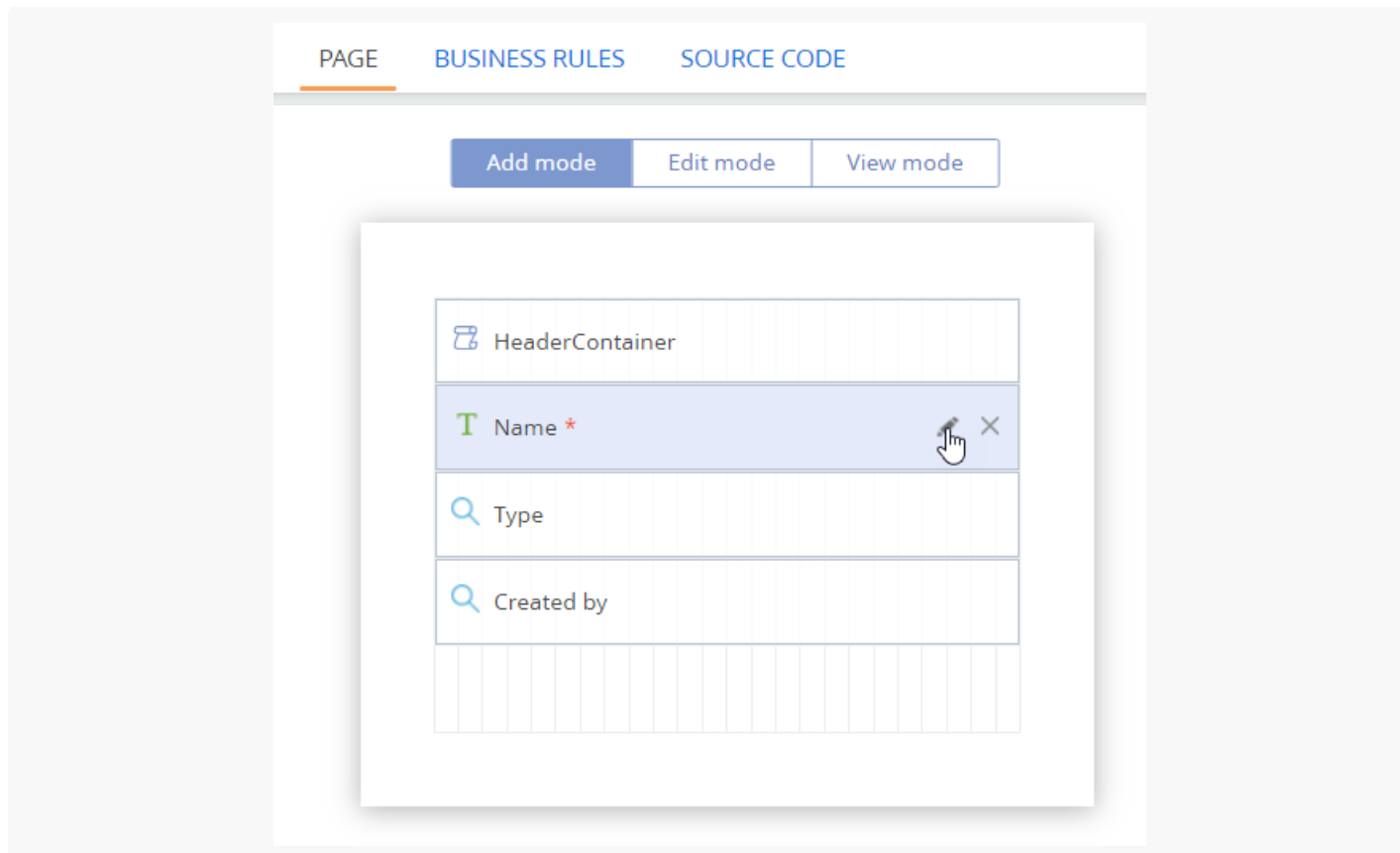

1. To configure the behavior of the fields on the mini page, you can use business rules.

Note. Working with business rules for mini page fields is similar to that of the regular section page fields. Read more >>>

Note. You can use the [*Source code*] tab to edit the source code of the mini page and customize it even further. The tab displays the source code of the page view module that was generated based on the changes you made during the previous steps. Learn more about working with the source code of Creatio modules in the “[Module designer](#)” article.

2. Click ← SECTION WIZARD to return to the Section Wizard.
3. Save the changes.

As a result, mini pages will become available in the section for selected functions. For example, if you enabled and set up the “Add mode” - a mini page will open when a user clicks [*New...*] in the section ([Fig. 4](#)). If you enabled and set up the “View mode” - the preview mini page will pop up when a cursor hovers over the section record link in any list that shows the records of this section ([Fig. 5](#)).

Fig. 4 Example of a mini page for adding a section record

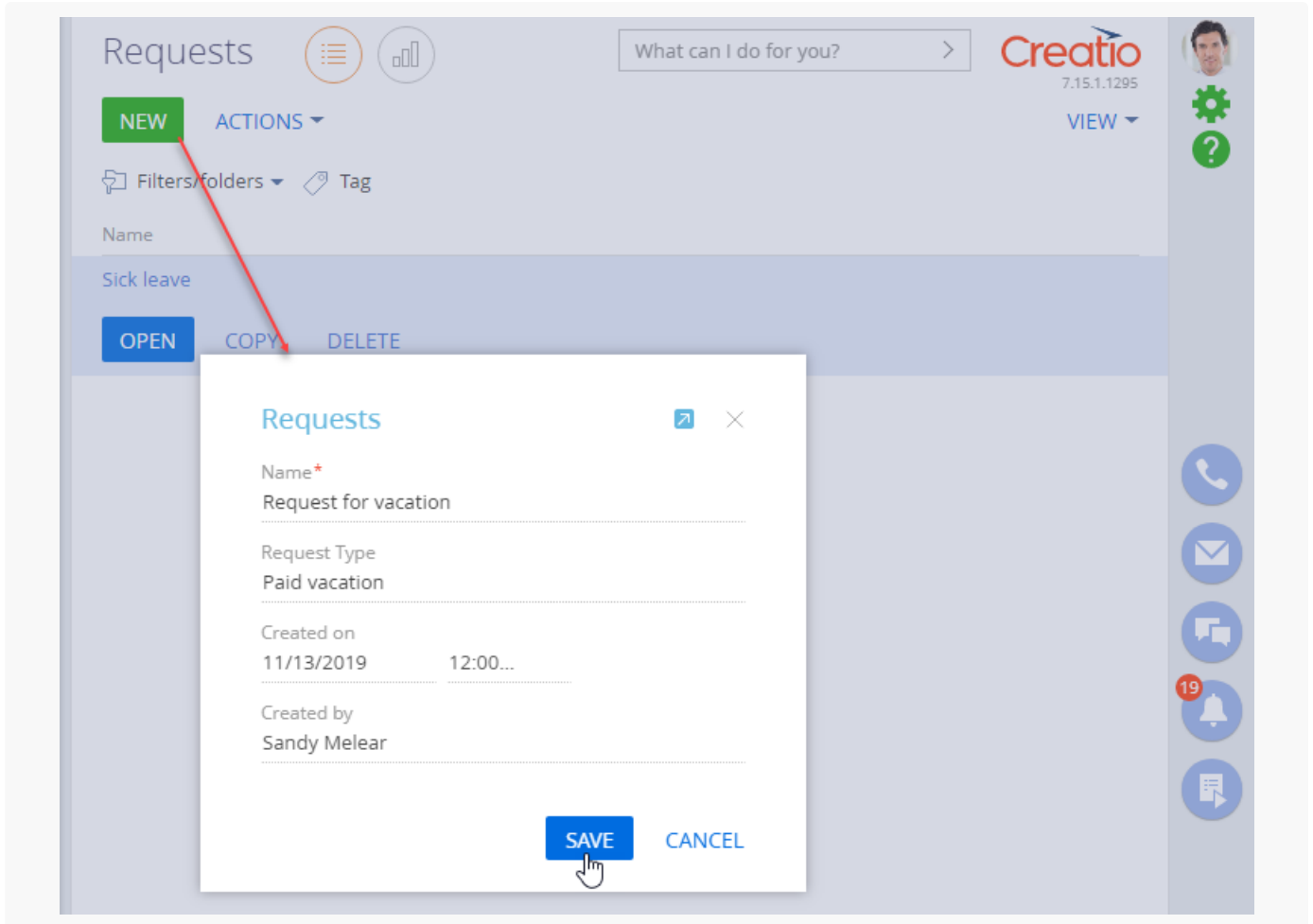

Fig. 5 Example of a mini page for previewing a section record

